

ANDAMIO TRADICIONAL
ELEMENTOS PARA DISTANCIA 3.000

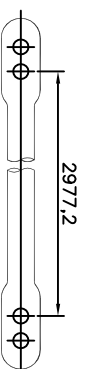

medida del tubo de partida
cruceta 3.340mm barandilla 3.100mm

ANDAMIO TRADICIONAL
ELEMENTOS PARA DISTANCIA 2.000

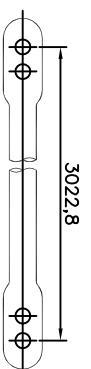
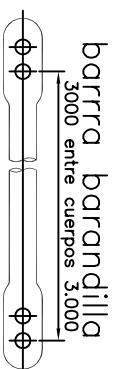
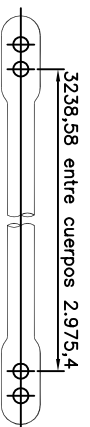
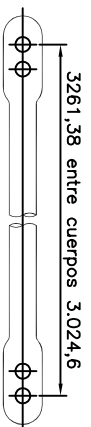
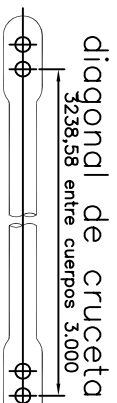
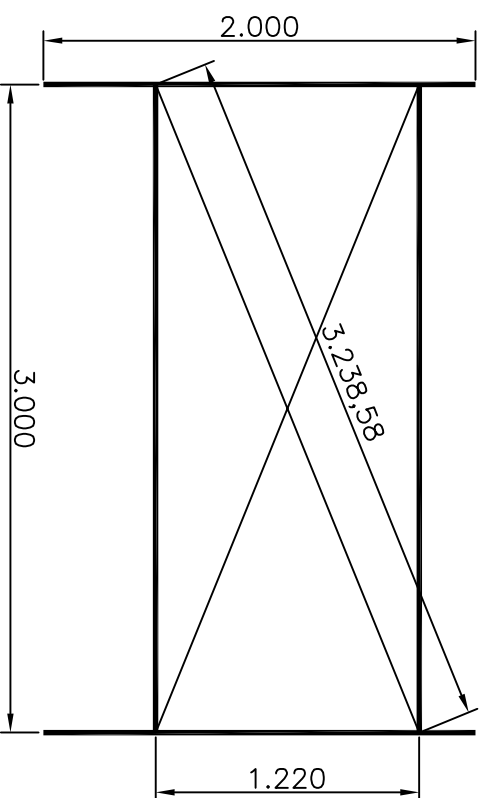
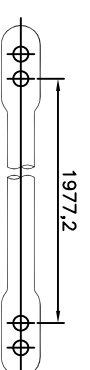
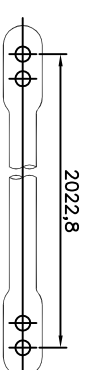
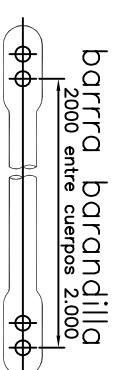
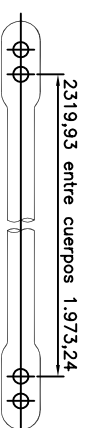
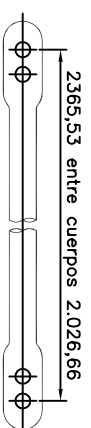
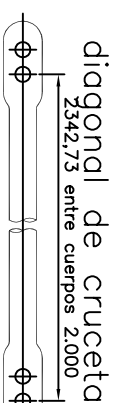
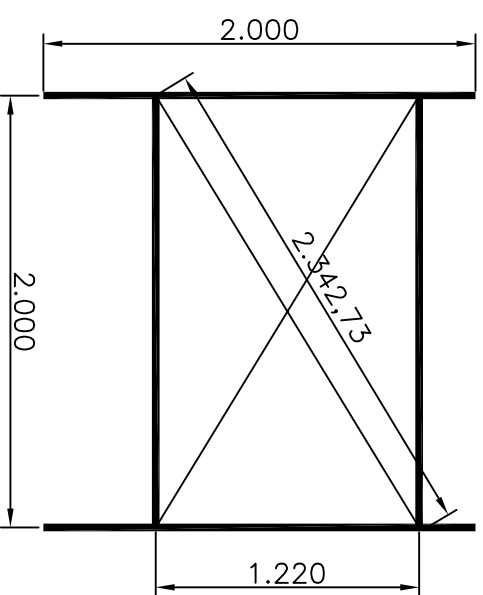

medida del tubo de partida
cruceta 2.445mm barandilla 2.100mm