

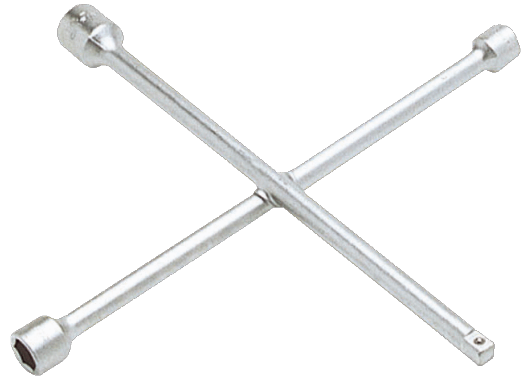

**29-B/BWXW1/BWXW2**  
**Llaves en cruz**



**DETALLES DEL PRODUCTO**



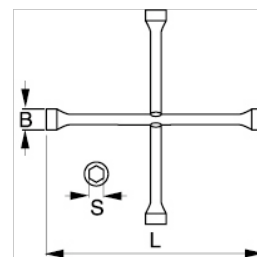

- Llaves en cruz de cuatro posiciones para trabajos pesados
- Diferentes modelos con distintas dimensiones para diferentes aplicaciones
- Aleación de acero de alto rendimiento
- Dureza: 43-48 HRC
- Acabado cromado
- De conformidad con las normas
- ISO 6788
- DIN 3119
- UNE 16518



**Follow the Fish!**



## ATRIBUTOS DE PRODUCTO

Producto	<b>S</b>	<b>B</b>	<b>L</b>					
<b>29-B</b>	17,19,21 mm	25, 27, 30 mm	408 mm	1/2"	408 mm	30 mm	410 mm	1.32 kg
<b>BWXW1</b>	17,19,22 mm	26,28,31 mm	380 mm	1/2"	380 mm	31 mm	380 mm	6.2 kg
<b>BWXW2</b>	24,27,32 mm	36,40,45 mm	695 mm	3/4"	695 mm	45 mm	695 mm	4.56 kg
<b>BWXW3</b>	17, 19, 21, 22 mm	25, 27, 29, 31 mm	378 mm	-	378 mm	30 mm	378 mm	1.27 kg
<b>BWXW4</b>	24, 27, 32, 38 mm	35, 40, 46, 52 mm	695 mm	-	695 mm	52 mm	695 mm	4.71 kg

Follow the Fish!

